

REVISIONS				
LTR	DESCRIPTION	E.C.N.	DATE	BY/APP'D
A	RELEASE TO DOCUMENT CONTROL	12532	12/06/2000	SN/TL/AL

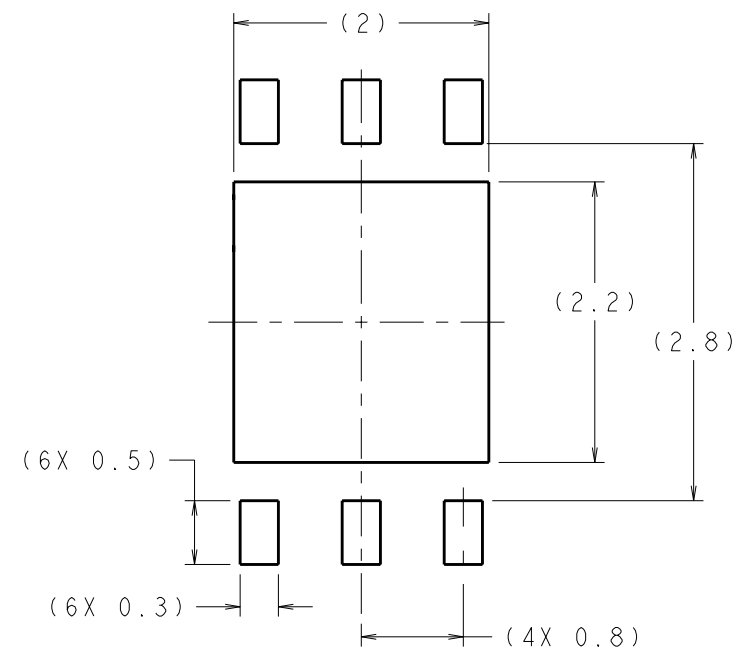

DIMENSIONS ARE IN MILLIMETERS

**RECOMMENDED LAND PATTERN**  
1:1 RATIO WITH PKG SOLDER PADS

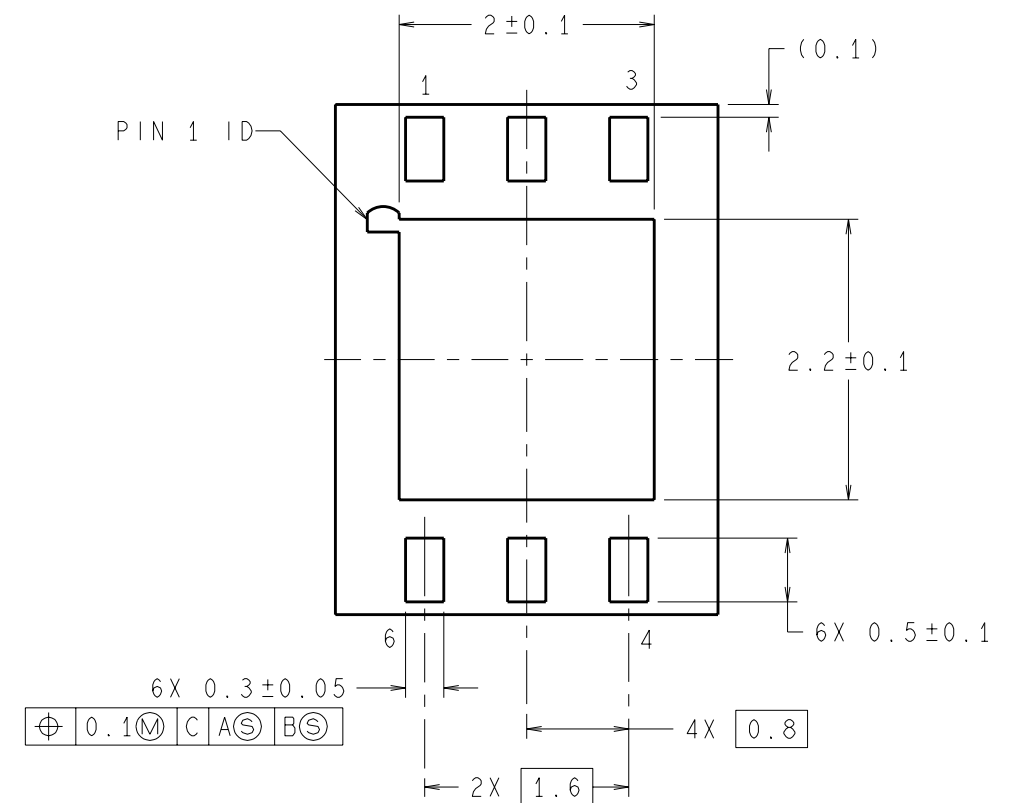
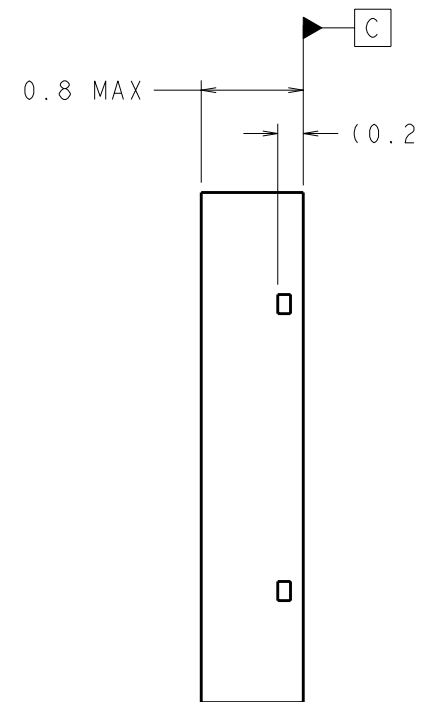
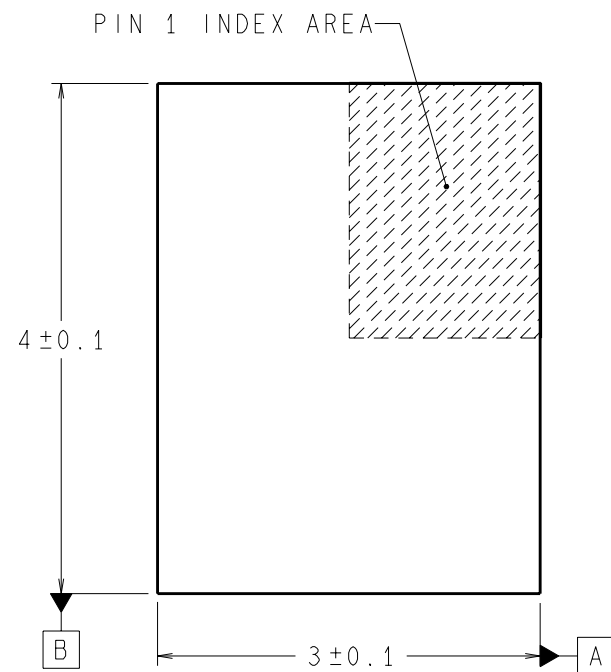

⊕	0.1	M	C	A	⊗	B	⊗
---	-----	---	---	---	---	---	---

NOTES: UNLESS OTHERWISE SPECIFIED.

- STANDARD LEAD FINISH TO BE 5.08 MICROMETERS MINIMUM LEAD/TIN (SOLDER) ON COPPER.
- NO JEDEC REGISTRATION AS OF DECEMBER 2000.

APPROVALS	DATE	National Semiconductor			
DRAWN N. SANTHIRAN & TL	12/06/2000	2900 Semiconductor Dr., Santa Clara, CA 95052-8090			
DFTG. CHK. THANH LEQUANG	12/06/2000	<b>LLP, PLASTIC, DUAL, 3 X 4 X 0.75 mm BODY, 6 LD, 0.8 mm PITCH</b>			
ENGR. CHK. ANTHONY LAW	12/06/2000				
		SCALE	SIZE	DRAWING NUMBER	REV
		N/A	C	(SC)MKT-LDC06D	A
		FORMERLY: N/A		SHEET 1 of 1	